

# Captive Transit Mounts

## FLANGED MOUNTINGS



A universal mounting, popular in a wide range of applications. Cost Effective, High Performing and Easy to Install. The rubber is used in shear compression providing optimum performance and offers vibration reduction of up to 95% in all axis. The metal top cap provides protection from contamination such as Oil and Fuel. Load Ratings from 20kg to 5,000kg.

Captive Transit Mounts are designed with an integral overload stop to control movement of the mounted equipment, during transit, and also provide a failsafe arrangement to control shock loads. Suitable for both Mobile and Static applications.

### Advantages:

- Failsafe Design – Ideal for Mobile Equipment
- High Performance Vibration Reduction
- Easy to Install
- Protection from Contamination

### Applications:

- Generating Sets
- Diesel Engines
- Marine Engines
- Construction and Plant Equipment
- Pumps and Compressors
- Industrial & Commercial Vehicles



# Square Flanged Captive Mounts

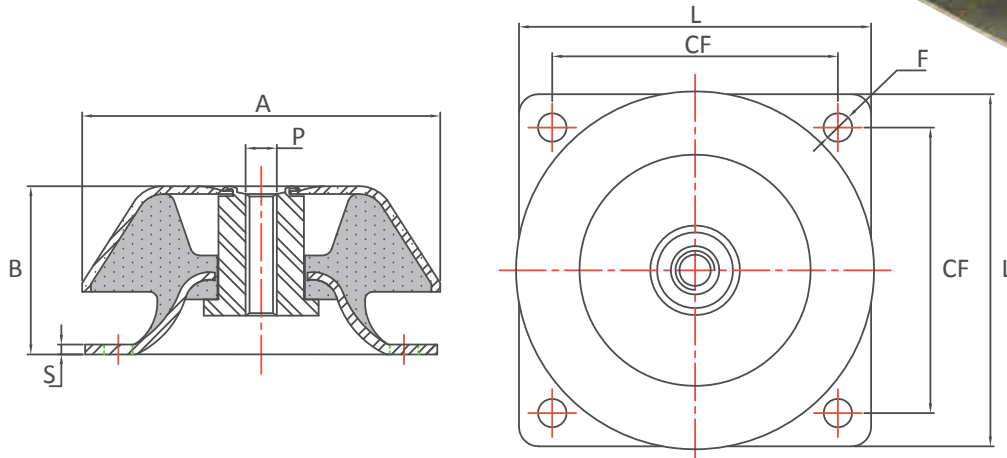

Part No	A	B	P	F	CF	L	S
SFCM150	150	50	M16	14.5	132	170	4
SFCM150HD	150	54	M16	14.5	132	170	4
SFCM160	162	59	M20	14.5	140	170	4
SFCM180	180	66	M20	14.5	149 - 163	192	5
SFCM180HD	183	86	M20	14.5	146	180	5
SFCM220	220	105	M24	17.5	180	220	6
SFCM220HD	220	105	M24	17.5	180	220	6

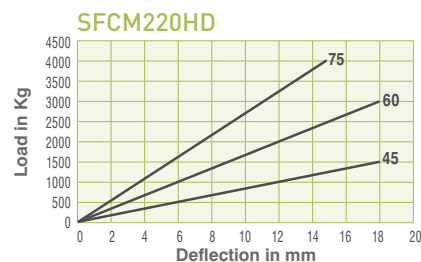
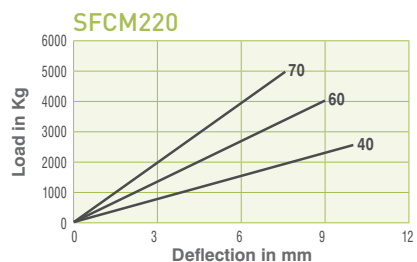
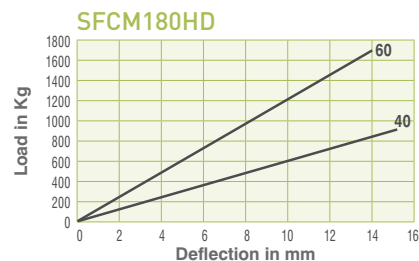
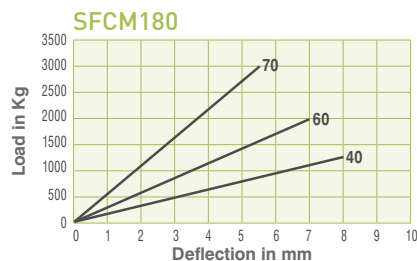
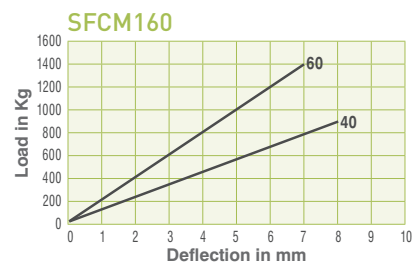
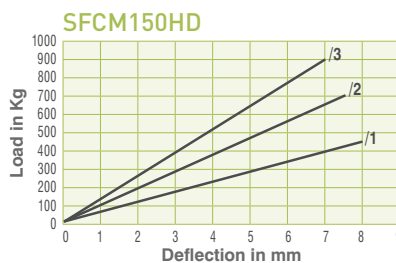
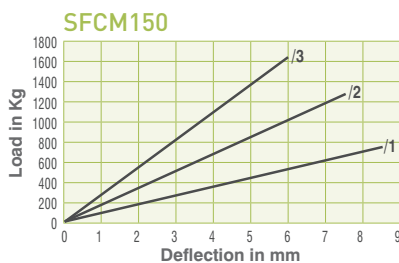

Max compression load in Kg deflection in mm.

This information is for guidance only. Customers are recommended to contact us for further technical information on products and applications. We reserve the right to alter specifications or withdraw products without notice.